

| 未注公差/General tolerances(mm) |       |       |       |       |       |       |       |       |       |       |       | 0.1/10 |       |
|-----------------------------|-------|-------|-------|-------|-------|-------|-------|-------|-------|-------|-------|--------|-------|
| 0                           | >3    | >6    | >10   | >18   | >30   | >50   | >80   | >120  | >180  | >250  | >315  |        | >400  |
| ~3                          | ~6    | ~10   | ~18   | ~30   | ~50   | ~80   | ~120  | ~180  | ~250  | ~315  | ~400  | ~500   | >500  |
| ±0.12                       | ±0.18 | ±0.22 | ±0.26 | ±0.31 | ±0.37 | ±0.57 | ±0.80 | ±0.93 | ±1.05 | ±1.15 | ±1.60 | ±2.20  | ±2.50 |

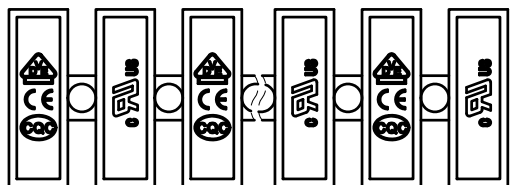
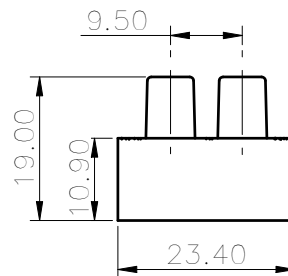
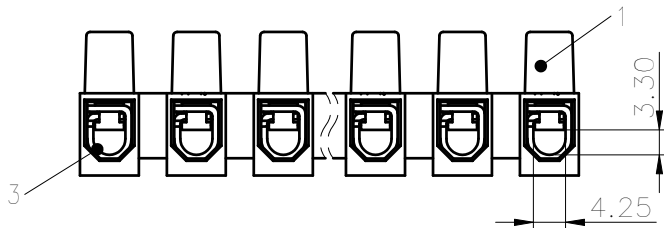
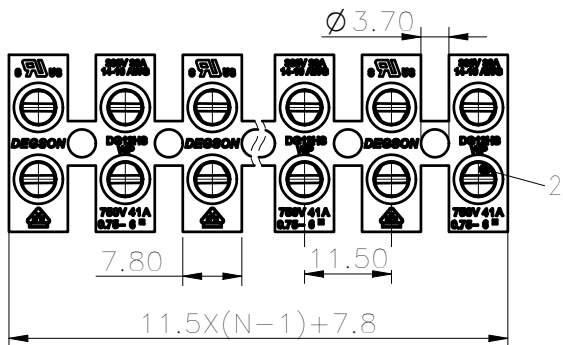

Note: The A&Z(H) in the name means: A(H) and Z(H).

| ITEM | NAME OF PART    | MATERIAL           | NOTES          |
|------|-----------------|--------------------|----------------|
| 3    | Current carrier | Steel+Copper alloy | Zn plated      |
| 2    | Screws          | Steel              | Zn Plated/M3.5 |
| 1    | Housing         | PA66               | UL94V-2        |

| UL 标准/UL Standard:   | B                | C | D      |
|--|------------------|---|--------|
| 额定电压/电流/Rated Voltage(V)/Current(A)                              | 300/30           | / | 300/10 |
| IEC 标准/IEC Standard:   |                  |   |        |
| 额定电压/电流/Rated Voltage(V)/Current(A)                              | 750/41           |   |        |
| 螺丝扭矩/Torque Tightening(N·m/Lb.in)                                | M3.5, 0.8/7.08   |   |        |
| 线径范围(硬线和软线)/Wire Range(rigid and flexible)(AWG/mm <sup>2</sup> ) | 14~10 / 0.75~6.0 |   |        |
| 间距/Pitch(mm)/线数范围/Poles  | 11.5/N=2~12P     |   |        |
| 使用温度范围/Operating temperature(°C)                                 | -40~+105         |   |        |
| 符合RoHS环保要求/Conform to RoHS                                       | Yes              |   |        |

|           |            |                               |                  |                |
|-----------|------------|-------------------------------|------------------|----------------|
|           |            | MATERIAL:                     | SURFACE:         |                |
|           |            | MAT. NO./REV:                 | / 00             |                |
| APPD: 蓝贵凡 | 2022.12.05 | NAME                          |                  |                |
| CHKD: 曹利彬 | 2022.12.05 | DG12HSWP-1.2-XXP-1Y-100A&Z(H) |                  |                |
| DRFT: 孙科豪 | 2022.12.05 | DRAWING NO.                   | TYPE             | DRAWING STATUS |
|           |            | 200015275                     | CUSTOMER DRAWING | 已发布            |
|           |            | SCALE                         | SHEET            |                |
|           |            | 1:1                           | 1/1              |                |

| REV | ECN | DESCRIPTION | DRFT | DATE |
|-----|-----|-------------|------|------|
| 00  |     |             |      |      |

Transfer or duplication of this document as well as the utilization or communication of its contents are prohibited unless explicit authorization is granted. Customers will be liable for compensation. All rights reserved for patent, utility model or design registrations. 非经书面授权, 严禁禁止转让、复制、利用、交加本文件的内容, 一经发现负赔偿责任, 侵权者将承担法律责任。 本公司保留对涉及发明、实用新型和外观设计的所有权利。